



L8 Chassis



Overview

Product overview

Detailed specification

Detailed specification

Optional kits

High adjust hinge Stand & Cable cover
Chassis stand or Chassis bumper
Fingerprint sensor or IrDA receiver



Overview

Smallest micro-ATX design for Full functionality.

More than 30% smaller than normal 12 liters SFF on market (only 8 liters). It will be the best business Small Form Factor Desktop, not only has a space-saving design, but also has high level of security and cable management . Features with high productivity and multi-purpose.



Easy Access

Full screw-less design allows you to easily access critical system components such as top cover, add-on card, memory, HDD and optical drive.

Expansion

4 * low profile slots create the strong expansion function
1 * 3.5" HDD
1 * 2.5" SSD

Security

Cable cover reduce clutter and provide a safe and easy cable management approach to prevent others from accessing the ports and wiring behind the system.
Fingerprint sensor
Loop for pad lock
Kensington lock
Special design of Solenoid lock

Space saving Function

The optional monitor stand supports monitors up to 27" wide screen, giving you ultimate flexibility for multiple roles. The L8 locates quickly and easily behind the screen on the stand itself, freeing up valuable desk space and can be powered from the same mains cable as the monitor for simple power management. We've even included the whole front I/O (Audio, Microphone and 2x USB port) in the stand for easy connection of memory keys and other peripherals.

Detailed specification



L8-B

L8-C

Chassis panel

L8-B / L8-C

Chassis dimension

305x280x97 mm

Material

Metal SGCC T=0.6mm / Plastic ABS94HB

Main Board form factor

Micro ATX (full size : 244 x 244mm)

Drive Bays

9.5 mm Slim ODD x1

Slim card reader (CF card , smart card, SD card)

3.5" internal HDDx1

2.5" SSD / HDD

PCI expansion slot

4 slots

Front I/O

USB2.0 x2

USB3.0 x2

USB 3.1 type-C slot x1

Audio/Mic.

Power switch

Power LED

HDD LED

Card reader

SD + CF + Smart card reader

Active speaker

2.5W

Chassis stand or Chassis bumper

Switching PSU

250W , 80+Bronze

Screw-less

Chassis Cover

PCI card

HDD

Slim ODD

Front bezel

Drive bay cage

Top cover

VESA mount hole 100x100 mm

Security

Kensington lock slot

Cable cover

pad lock

Solenoid lock

Intrusion switch

Fingerprint sensor or IrDA receiver with lock

High adjust hinge Stand

Support LCD monitor VESA 1&2

Support LCD monitor Wide - Screen 17"~24"

Monitor loading Weight : 3.5kgs ~5.5kgs

Monitor height adjusting distance: 100mm

90° panel rotate

Front accesses : USB3.0 x2 / Microphone / Headset

Detailed specification

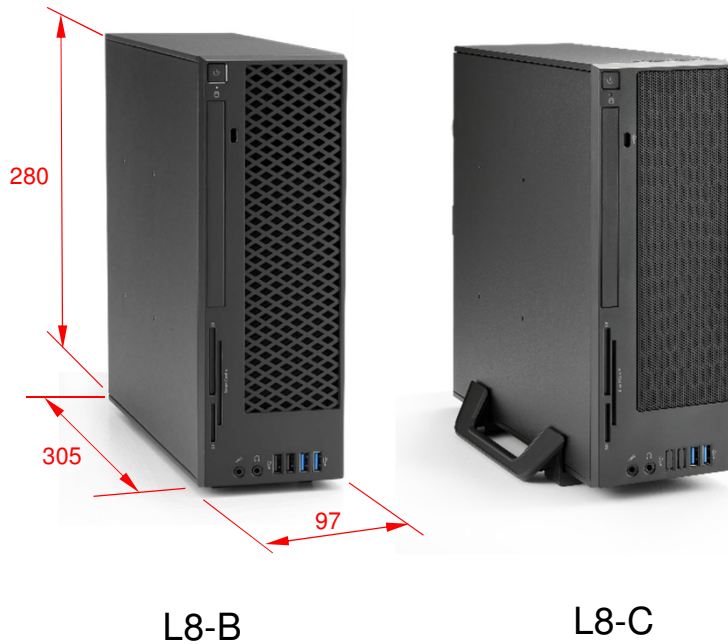

Chassis panel

L8-B / L8-C

Chassis dimension

305x280x97 mm

Material

Metal SGCC T=0.6mm / Plastic ABS94HB

Main Board form factor

Micro ATX (full size : 244 x 244mm)

Drive Bays

9.5 mm Slim ODD x1
Slim card reader (CF card , smart card, SD card)
3.5" internal HDDx1
2.5" SSD / HDD

PCI expansion slot

4 slots

Front I/O

USB2.0 x2
USB3.0 x2
USB 3.1 type-C slot x1
Audio/Mic.
Power switch
Power LED
HDD LED

Card reader

SD + CF + Smart card reader

Active speaker

2.5W

Chassis stand or Chassis bumper

Switching PSU

250W , 80+Bronze

Screw-less

Chassis Cover
PCI card
HDD
Slim ODD
Front bezel
Drive bay cage

Top cover

VESA mount hole 100x100 mm

Security

Kensington lock slot
Cable cover
pad lock
Solenoid lock
Intrusion switch
Fingerprint sensor or IrDA receiver with lock

High adjust hinge Stand

Support LCD monitor VESA 1&2
Support LCD monitor Wide - Screen 17"~24"
Monitor loading Weight : 3.5kgs ~5.5kgs
Monitor height adjusting distance: 100mm
90° panel rotate
Front accesses : USB3.0 x2 / Microphone / Headset

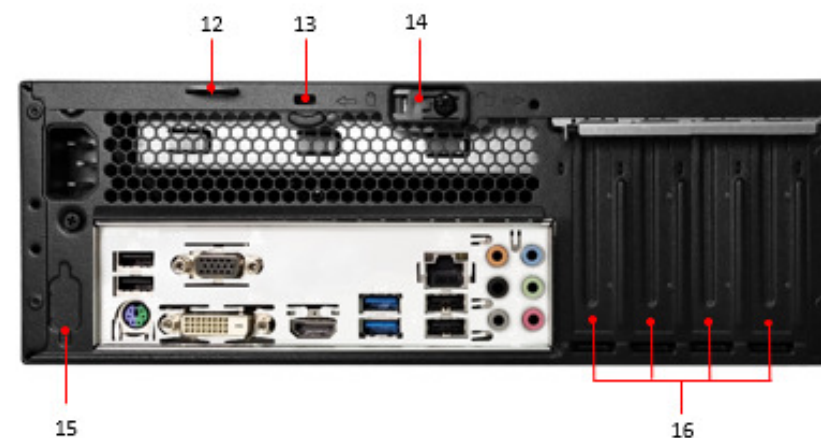

Detailed specification

1. Microphone
2. Headset
3. USB2.0 x2
4. USB3.0 x2
5. 4 in 1 SD card
6. Smart card reader

7. CF card
8. Slim ODD 9.5mm height
9. USB 3.1 Type-C slot
10. Power LED
11. Power switch
12. Pad lock metal loop

13. Kensington lock slot
14. Top cover latch
15. COM port slot
16. PCI expansion slots x4

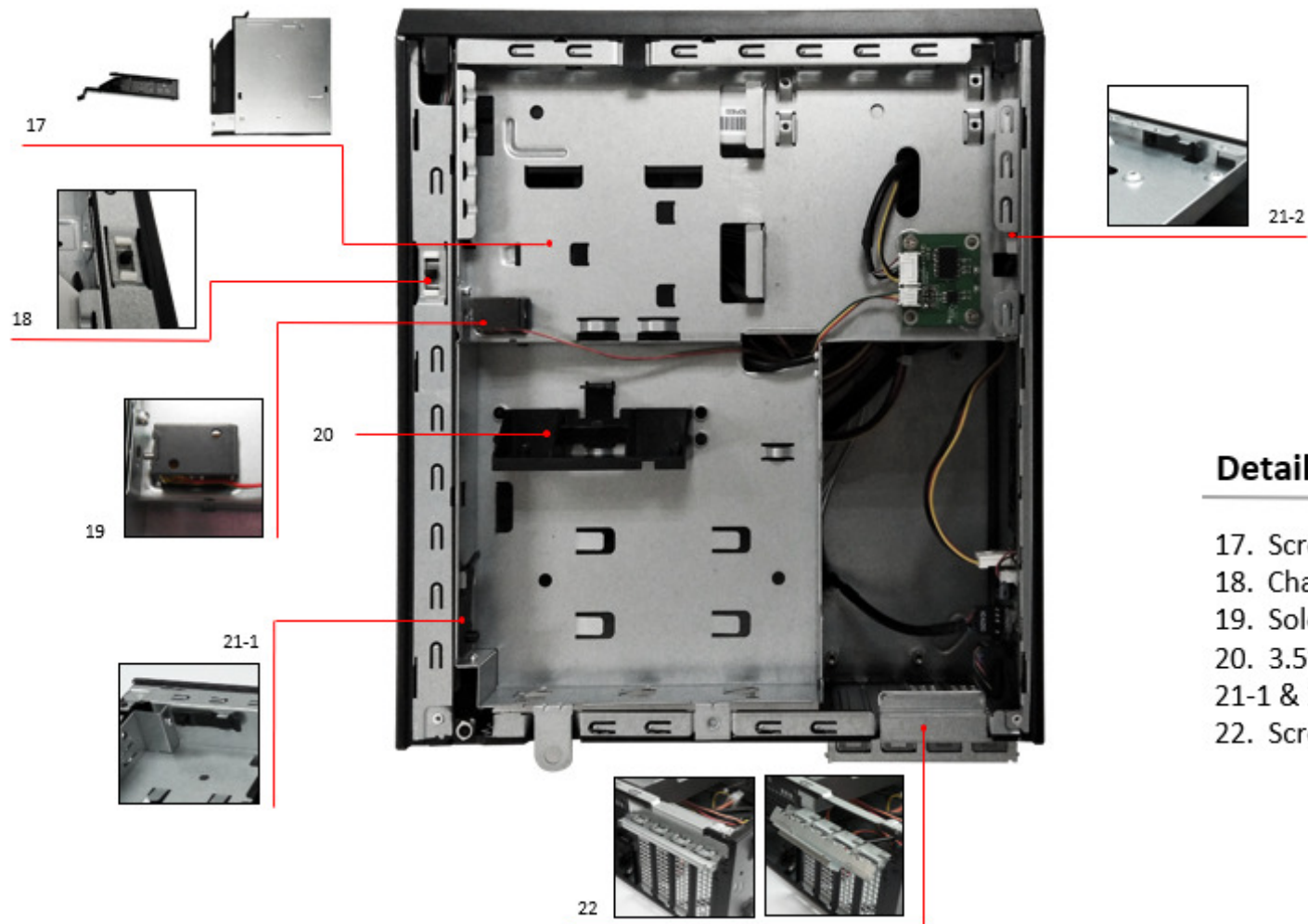

Detailed specification

- 17. Screw-less optical drive latch
- 18. Chassis intrusion switch
- 19. Solenoid lock
- 20. 3.5" HDD screw-less latch
- 21-1 & 21-2. Screw-less Drive bay clip
- 22. Screw-less PCI slot clip

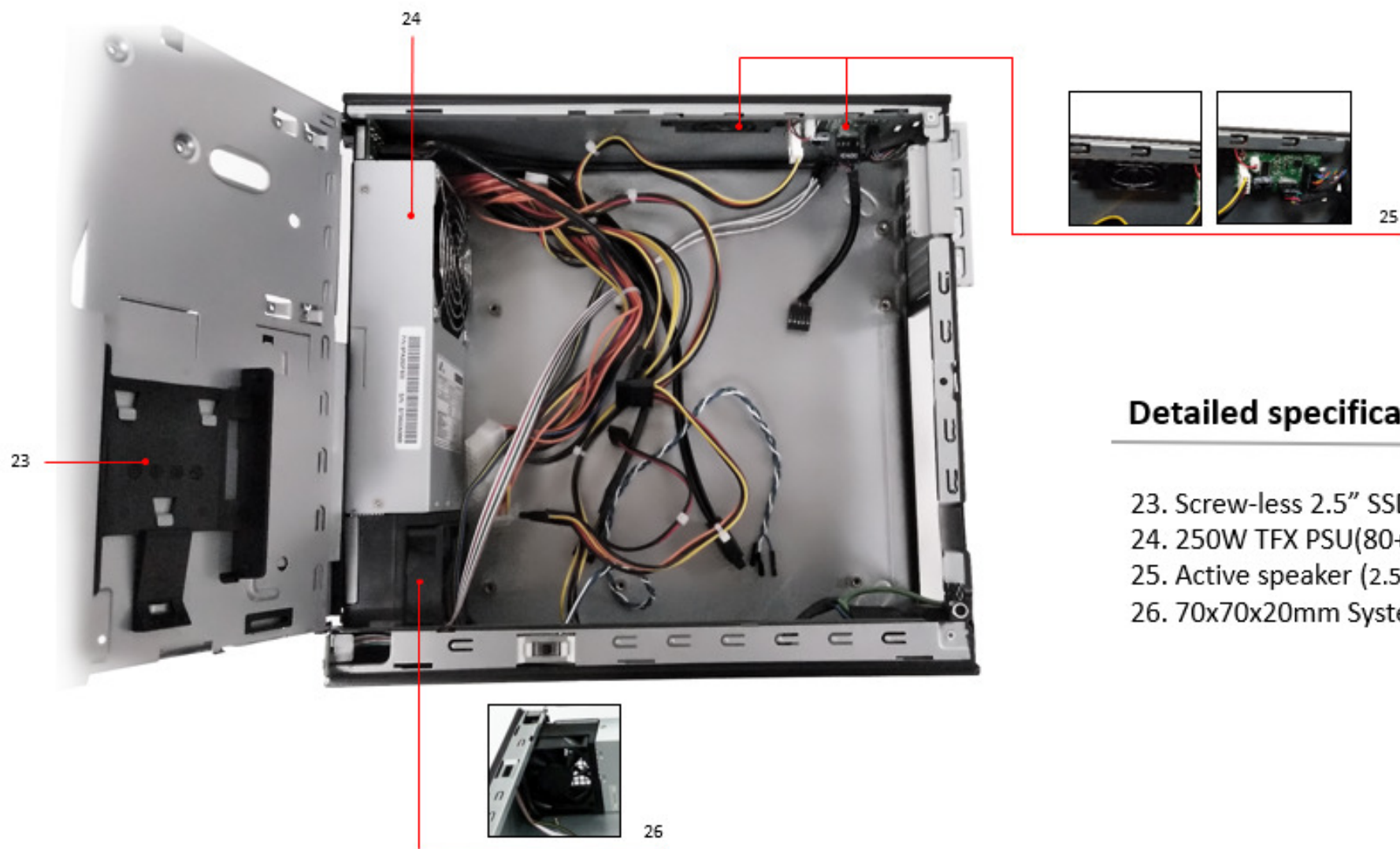

Detailed specification

- 23. Screw-less 2.5" SSD / HDD drive bay
- 24. 250W TFX PSU(80+Bronze)
- 25. Active speaker (2.5w)
- 26. 70x70x20mm System FAN



High adjust hinge Stand & Cable cover

1. 100mm High adjust hinge stand with 90° VESA tray rotate function(max. monitor weight up to 5.5kg)
2. Cable cover with Kensington lock slot
3. USB3.0 x2
4. Microphone
5. Headset

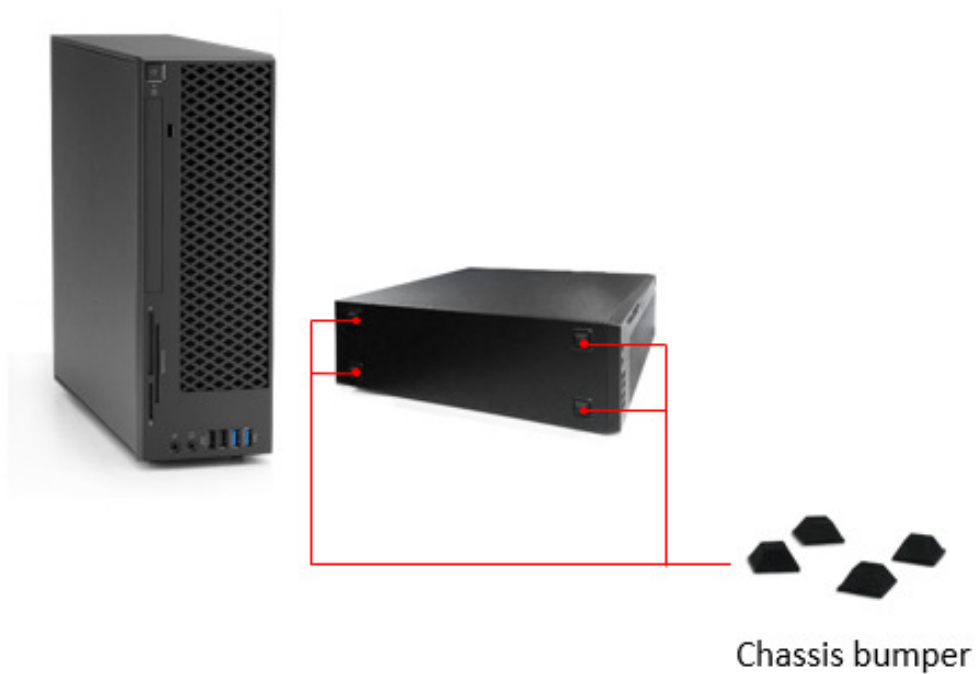

Chassis stand or Chassis bumper





Fingerprint sensor or IrDA receiver with lock